

# Quickdraw®

## CONVEYOR SYSTEMS

### *Connecting Your Workplace*

Quickdraw designs and manufactures conveyor systems for factory automation. A full line of modular components, both standard and custom, are ideal for micro-electronics, automotive sub-assemblies, medical, laboratory, semiconductor, and many other applications. The company serves domestic and international markets.



# CLEANROOM

## OFFERS GREATER FLEXIBILITY WITH 50% SMALLER FOOTPRINT

A new patented, compact conveyor designed with a low profile and narrow rails offers greater flexibility in tight spaces. With a conveyor height of only 2-7/8" and an overall conveyor width that is only 1-1/2" wider than the transport tray, the

new conveyor yields a footprint 50% smaller than competitors' product. The compact systems can be configured with accessories to complete any desired layout, including precise stops to locate a product for tight tolerance processing.

Along with its compact size, the Quickdraw brand conveyor includes full featured functionality. Its patented technology incorporates innovative clean roller design with the Quickdraw Zone Buffering® and Intellizone™ technology. Sensor, logic, and motor controls are all built into the conveyor rail. The control system is self-contained with plug and go operation so no

PLC is needed to set-up or operate the conveyor.

This cleanroom conveyor is the simplest to integrate and one of the easiest to maintain even in Class-1 Cleanroom environments. No belts are used and the only moving elements are sealed ball bearings which eliminates debris as well as the need to service and replace belts.



1.800.473.8837

[www.qdraw.com](http://www.qdraw.com)

# Quickdraw®

## CONVEYOR SYSTEMS

### Connecting Your Workplace

# CLEANROOM

Low profile rail offered with fixed or adjustable width incorporates T-slot design to accommodate mounting of accessories. ESD safe. Available in standard and custom configurations. Ideal for OEM applications.

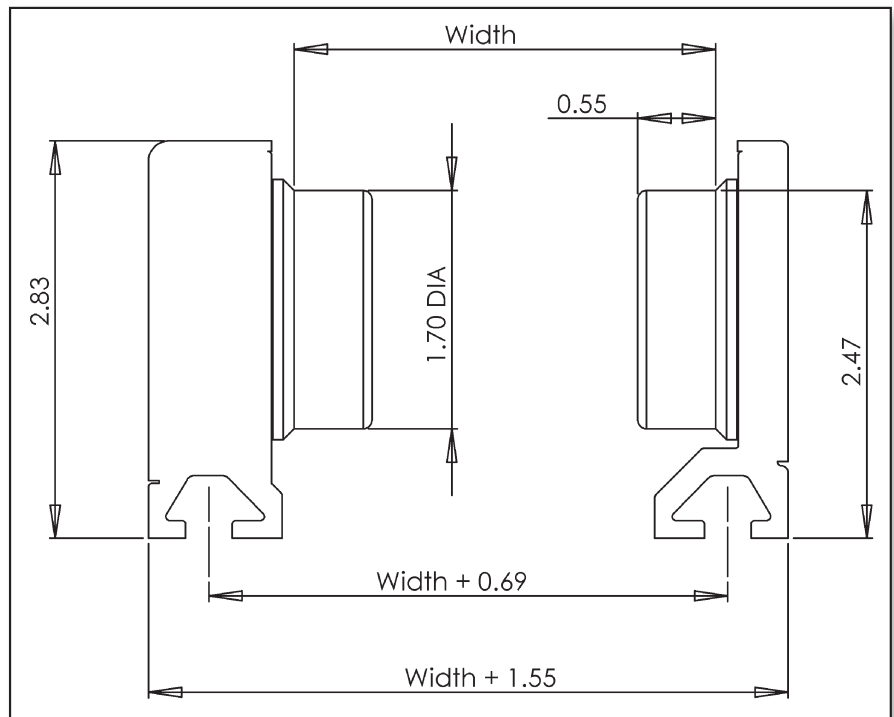
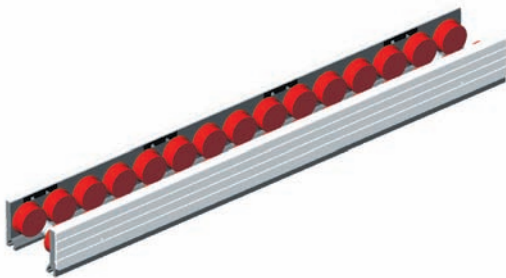

<b>Cleanliness</b>	Class 1 Fed. Std. 209-E (ISO Class 3)
<b>Speed</b>	5 to 15 inches per second
<b>Zone Size</b>	min: 8" • max: N/A
<b>Pallet or Part Size</b>	min: 4" length, 1.5" width • max: N/A
<b>Pallet or Part Weight</b>	min: N/A • max: 1.5 lbs./ inch
<b>Conveyor Lengths</b>	available in 2" increments
<b>Power requirements</b>	24 VDC, 0.5 Amp typical per zone
<b>Features</b>	Bi-directional ESD Safe T-slot design incorporated in rail Plug and play buffering standard Optional PLC monitoring/control
<b>Auxiliary Devices</b>	Elevators, diverters, shuttles, & corner rotates